

Instructions for setting up of remote access to the Scopus database

Step 1. Click "Sign in" on the homepage of [Scopus](#) database:

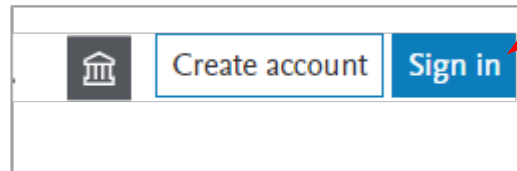

Step 2. On the login page click "Use another account" button:

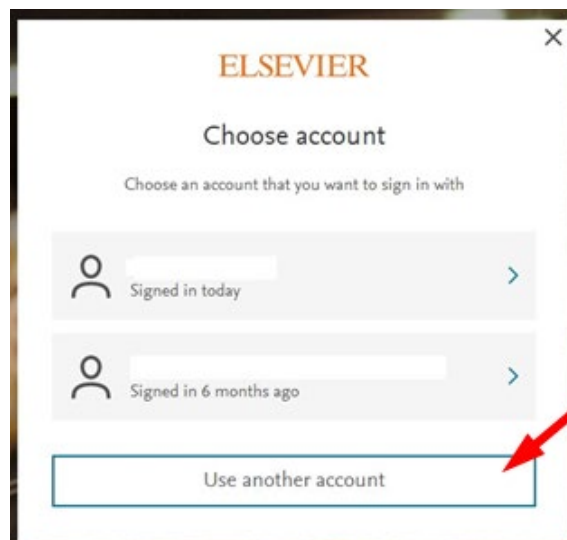

Step 3. On the welcome page, please click the "Sign in via your institution":

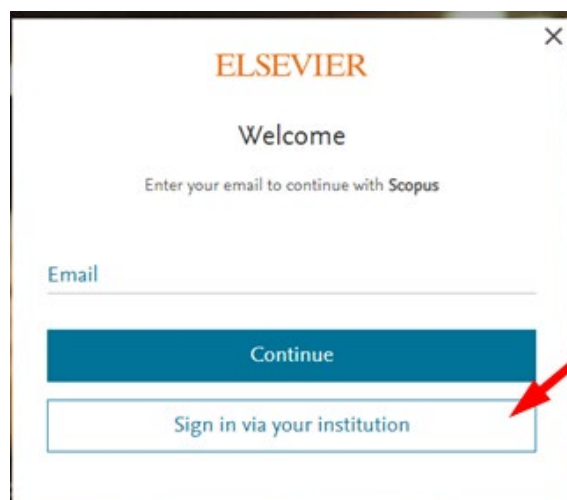

Step 4. Enter the corporate e-mail (*****@nuph.edu.ua) and click "Continue":

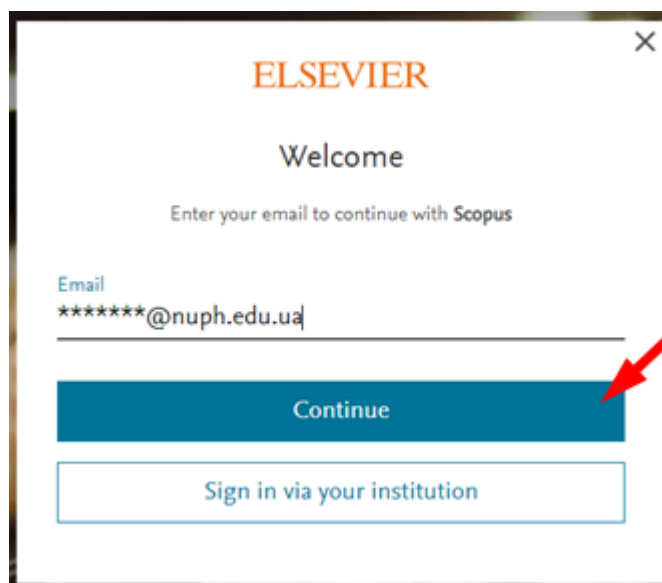

ELSEVIER

Welcome

Enter your email to continue with Scopus

Email

*****@nuph.edu.ua

Continue

Sign in via your institution

Step 5. Check your corporate email, you will receive an activation link for your remote access.

If you have any additional questions, please contact the Scientific Library:
library@nuph.edu.ua.